

2 Switch Operation and Interconnection using 'Wye' Dual Port Harness

Applicable to:

- ✓ Premium valves
- ✓ Standard valves

DM Parts Numbers Interconnection for 2 Switch Operation using 4 Pin to 4 Pin Plug Extension and 4 Pin Plug Switch

Optional Extension Cables for 4 Pin Plug Configuration.

Determine required length then use Cross Reference Table for DM PN

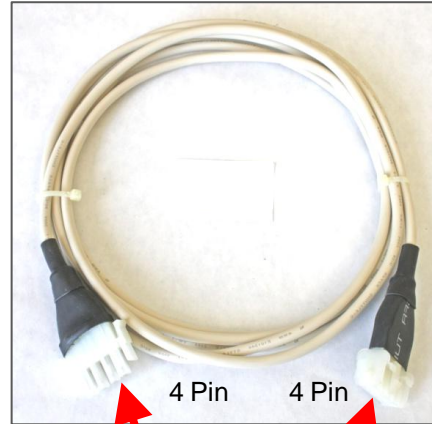
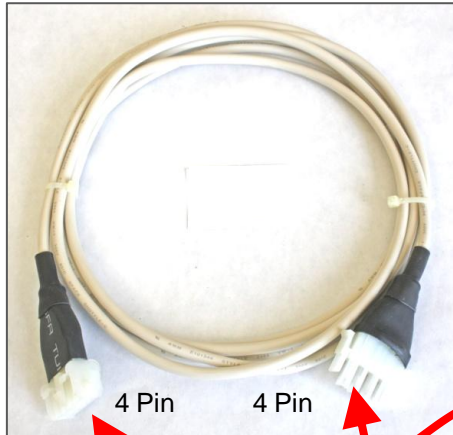

Cross Reference Table	
Extension Length	DM PN
0 Feet	Not Required
0 to 2 Feet	DM 5218
>2 to 4 Feet	DM 5525
> 4 to 6 Feet	DM 5227
> 6 to 10 Feet	DM 5219
> 10 to 12 Feet	DM 5220
> 12 to 20 Feet	DM 5223
> 20 Feet	Custom Cable

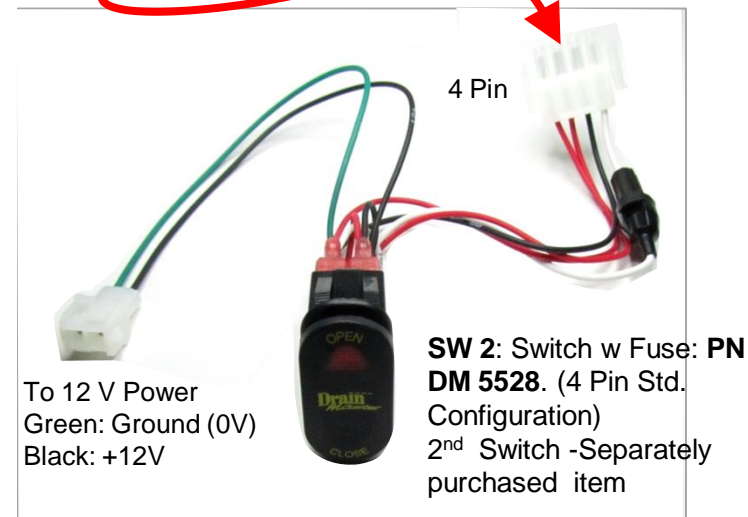
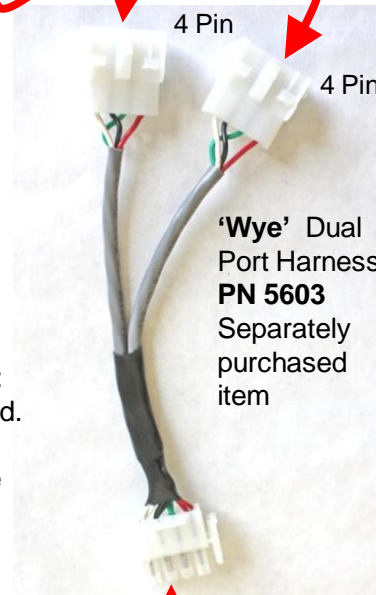
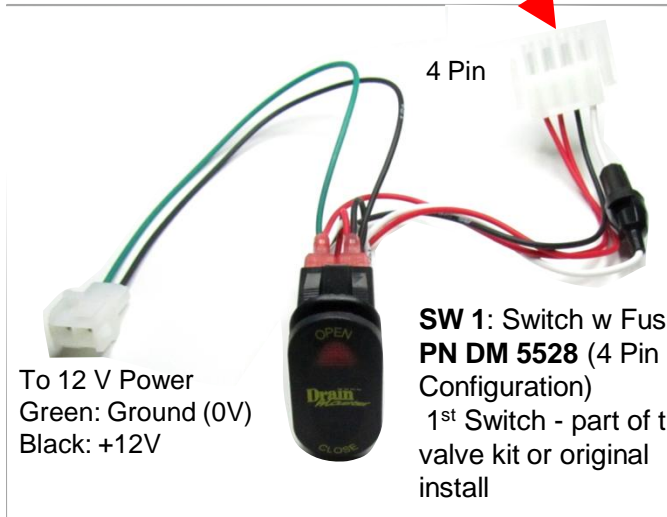

↕ To Valve 4 Pin to 4 Pin

DM Parts Numbers Interconnection for 2 Switch Operation with 4 Pin to Dual 2 Pin Extension and Dual 2 Pin Switch.

Extension Cables are **REQUIRED** in 4 Pin to Dual 2 Pin Configuration.

Determine required length, then use Cross Reference Table for DM PN

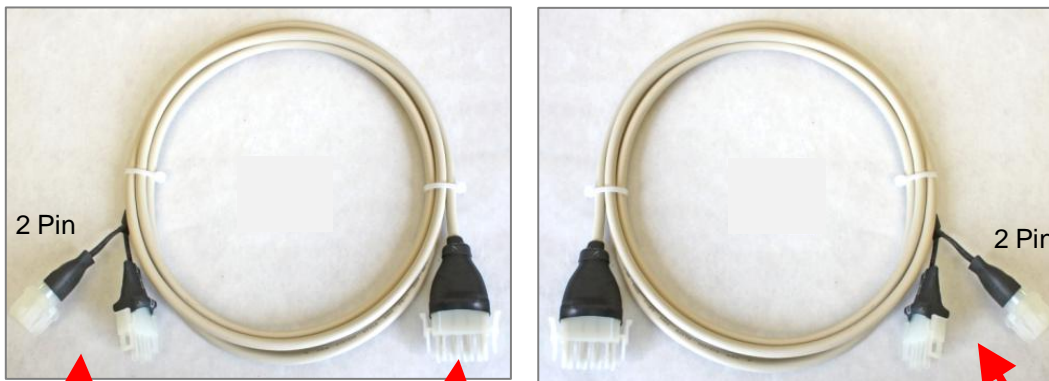

Cross Reference Table	
Extension Length	DM PN
0 to 2 Feet	DM 5218 -1
> 2 to 4 Feet	DM 5525 -1
> 4 to 6 Feet	DM 5227-1
> 6 to 10 Feet	DM 5219 -1
> 10 to 12 Feet	DM 5220 -1
>12 to 20 Feet	DM 5223 -1
> 20 Feet	Custom Cable

Note: 2 Pin Plug bodies are so polarized as to ensure correct mating.

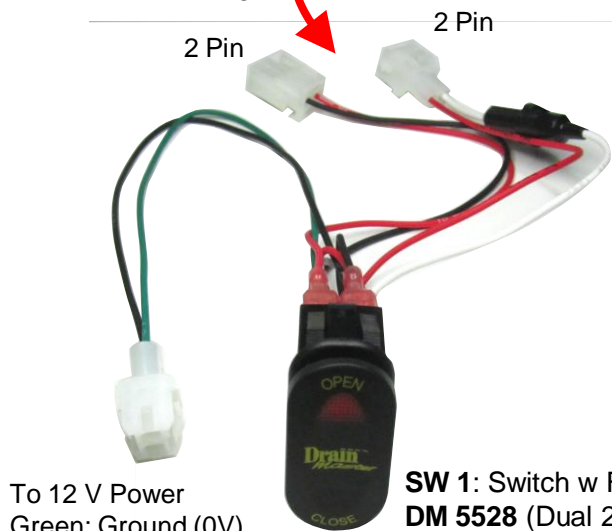

To 12 V Power
Green: Ground (0V)
Black: +12V

SW 1: Switch w Fuse: PN DM 5528 (Dual 2-Pin Configuration)
1st Switch - Part of the valve kit or original install

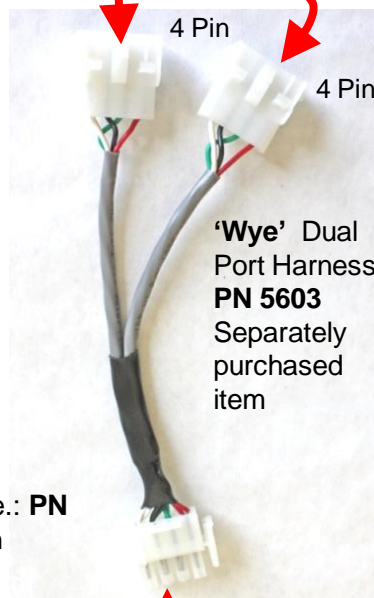

'Wye' Dual Port Harness
PN 5603
Separately purchased item

↕ To Valve 4 Pin to 4 Pin



To 12 V Power
Green: Ground (0V)
Black: +12V

SW 2: Switch w Fuse: PN DM 5528 (Dual 2-Pin Configuration)
2nd Switch - Separately purchased item